

NATIONAL ORGANIZATION
SONS OF UNION VETERANS OF THE CIVIL WAR
 CIVIL WAR MEMORIAL ASSESSMENT FORM

PLEASE:

- Type or print, using a ball-point pen, when filling out this form. Legibility is critical.
- Do not guess at the information. An answer of, "Unknown," is more helpful.
- Include a photograph of each viewable side and label it with name & direction of view.

- Thank You.

Type of Memorial

Monument *with* Sculpture Monument with *Cannon*
 Monument *without* Sculpture Historical Marker Plaque

Affiliation

G.A.R. (Post Name & No. _____) M.O.L.L.U.S.
 W.R.C. (Corps Name & No. _____) Other Allied Order
 SUVCW (Camp Name & No. _____) (Please describe below)
 DUVCW (Tent Name & No. _____)
 Other: Missouri Department of Conservation _____

Original Dedication Date Unknown Please consult any/all newspaper archives for a local paper's article that would have information on the *first* dedication ceremony and/or other facts on the memorial. Please submit a copy of your findings with full identification of the paper & date of publication. Thank you.

Location

The Memorial is *currently* located at:

Street/Road address or site location County Road 228 at St Francis River W90° 09'22" N36° 29'03"

City/Village Campbell Township _____ County Dunklin

The front of the Memorial faces: North South East West

Government Body, Agency, or Individual Owner (of private cemetery that Memorial is located in)...

Name Missouri Dept of Conservation Dept./Div. _____

Street Address PO Box 180

City Jefferson City State MO Zip Code 65102

Contact Person _____ Telephone (573) 751-4115

If the Memorial has been moved, please list former location(s)...

N/A

Physical Details

Material of Monument or base under a Sculpture or Cannon = Stone Concrete Metal Undetermined

If known, name specific material (color of granite, marble, etc.) Wood

Material of the Sculpture = Stone Concrete Metal Undetermined
If known, name specific material (color of granite, marble, etc.) _____
If the Sculpture is of metal, is it solid cast or "hollow?" _____

Material of Plaque or Historical Marker / Tablet = Wood _____

Material of Cannon = Bronze Iron - Consult known Ordnance Listing to confirm
Markings on muzzle = _____
Markings on Left Trunion _____ Right Trunion _____
Is inert ammunition a part of the Memorial? If so, describe _____

Approximate Dimensions (indicate unit of measure) - taken from tallest / widest points
Monument or Base: Height 6 1/2 ft Width 4 ft Depth 7 in or Diameter _____
Sculpture: Height _____ Width _____ Depth _____ or Diameter _____

For Memorials with multiple Sculptures, please record this information on a separate sheet of paper for each statue and attach to this form. Please describe the "pose" of each statue and any weapons/implements involved (in case your photos become separated from this form). Thank you!

Markings/Inscriptions (on stone-work / metal-work of monument, base, sculpture)
Maker or Fabricator mark / name? If so, give name & location found _____

The "Dedication Text" is formed: cut into material raised up from material face

Record the text (indicate any separation if on different sides...) Please use additional sheet if necessary.
On May 1-2, 1863 5000 Confederates Led By General Marmaduke Fought A Union Force of 8000 Led By McNeil And
Vandever. This Spot Was The Final Battle Of Marmaduke's Missouri Invasion. The Confederates Crossed The Flooded St.
Francis On A Makeshift Floating Barge.

Environmental Setting

(The general vicinity and immediate locale surrounding a memorial can play a major role in its overall condition.)

Type of Location

- | | | |
|---|--|--|
| <input type="checkbox"/> Cemetery | <input checked="" type="checkbox"/> Park | <input type="checkbox"/> Plaza/Courtyard |
| <input type="checkbox"/> "Town Square" | <input type="checkbox"/> Post Office | <input type="checkbox"/> School |
| <input type="checkbox"/> Municipal Building | <input type="checkbox"/> State Capitol | Other: _____ |
| <input type="checkbox"/> Courthouse | <input type="checkbox"/> College Campus | _____ |
| <input type="checkbox"/> Traffic Circle | <input type="checkbox"/> Library | _____ |

General Vicinity

Rural (low population, open land) Suburban (residential, near city)
 Town Urban / Metropolitan

Immediate Locale (check as many as may apply)

Industrial Commercial
 Street/Roadside within 20 feet Tree Covered (overhanging branches)
 Protected from the elements (canopy or enclosure, indoors)
 Protected from the public (fence or other barrier)
 Any other significant environmental factor _____

Condition Information

Structural Condition (check as many as may apply)

The following section applies to Monuments *with* Sculpture, and Monuments without _____ Sculpture - including the base for Monuments with *Cannon*. Instability in the sculpture and its base can be detected by a number of factors. Indicators may be obvious or subtle. Visually examine the sculpture and its base.

Sculpture	_____	Base
If hollow, is the internal support unstable/exposed? (look for signs of exterior rust)	_____	_____
Any evidence of structural instability? (look for cracked joints, missing mortar or caulking or plant growth)	_____	_____
Any broken or missing parts? (look for elements (i.e., sword, musket, hands, arms, etc. - missing due to vandalism, fluctuating weather conditions, etc.)	_____	_____
Any cracks, splits, breaks or holes? (also look for signs of uneven stress & weakness in the material)	_____	_____

Surface Appearance (check as many as may apply)

	Sculpture	Base
Black crusting	<input type="checkbox"/>	<input type="checkbox"/>
White crusting	<input type="checkbox"/>	<input type="checkbox"/>
Etched, pitted, or otherwise corroded (on metal)	<input type="checkbox"/>	<input type="checkbox"/>
Metallic staining (run-off from copper, iron, etc.)	<input type="checkbox"/>	<input type="checkbox"/>
Organic growth (moss, algae, lichen or vines)	<input type="checkbox"/>	<input type="checkbox"/>
Chalky or powdery stone	<input type="checkbox"/>	<input type="checkbox"/>
Granular eroding of stone	<input type="checkbox"/>	<input type="checkbox"/>
Spalling of stone (surface splitting off)	<input type="checkbox"/>	<input type="checkbox"/>
Droppings (bird, animal, insect remains)	<input type="checkbox"/>	<input type="checkbox"/>
Other (e.g., spray paint graffiti) - Please describe...	<input type="checkbox"/>	<input type="checkbox"/>
Good Shape		

Does water collect in recessed areas of the Memorial? Yes No Unable to tell

Surface Coating

Does there appear to be a coating? Yes No Unable to determine
If known, identify type of coating.

Gilded Painted Varnished Waxed Unable to determine

Is the coating in good condition? Yes No Unable to determine

Basic Surface Condition Assessment (check one)

In your opinion, what is the general appearance or condition of the Memorial?

Well maintained Would benefit from treatment In urgent need of treatment Unable to determine

Overall Description

Briefly describe the Memorial (affiliation / overall condition & any concern not already touched on) .

n/a

Supplemental Background Information

In addition to your on-site survey, any additional information you can provide on the described Memorial will be welcomed. Please label each account with its source (author, title, publisher, date, pages). Topics include any reference to the points listed on this questionnaire, plus any previous conservation treatments - or efforts to raise money for treatment. Thank you.

Inspector Identification

Date of On-site Survey 11/14/2008

Your Name Walter E Busch, US Grant Camp 68

Address PO Box 381 City Arcadia

State MO Zip Code 63621 Telephone (314) 630-8407

Please send this completed form to:

Kevin P. Tucker, PDC, Chair
58 Forest Street
Wakefield, MA 01880
(617) 595-7721

Thank you for your help, and attention to detail.

SONS OF UNION VETERANS OF THE CIVIL WAR
National Civil War Memorials Committee

CHALK BLUFF TRAIL ACCESS

DUNKLIN COUNTY
83 ACRES

Take Hwy 62 south from Campbell,
then right 3 miles on Co. Rd 232,
and left 1.25 miles on Co. Rd 228
to St. Francis River.

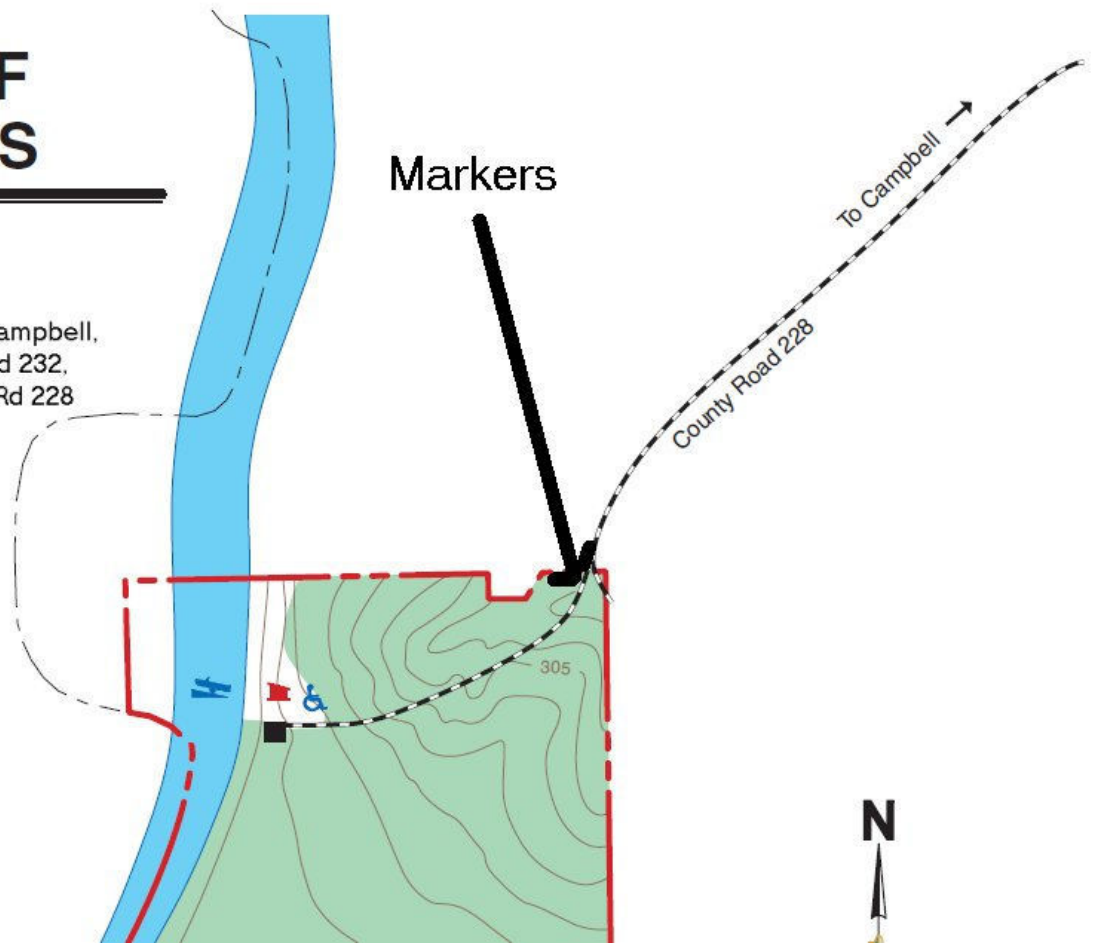

ON MAY 1-2, 1863 5000 CONFEDERATES
LED BY GENERAL MARMADUKE FOUGHT
A UNION FORCE OF 8000 LED BY
MCNEIL AND VANDEVER. THIS SPOT WAS
THE FINAL BATTLE OF MARMADUKE'S
MISSOURI INVASION. THE CONFEDERATES
CROSSED THE FLOODED ST. FRANCIS ON
A MAKESHIFT FLOATING BARGE.